

FIRST FLOOR PLAN

Planning Permit No. A/1844/B/C/92
APPROVED
 SUBJECT TO THE CONDITIONS IN THIS OFFICE LETTER.
 No. A/1936/92 Date 11-92
 0/c
 27/11/92
 30/11/92
 FOR MEMBER SECRETARY
 MADRAS METROPOLITAN
 DEVELOPMENT AUTHORITY
 MADRAS - 600 008.

| | |
|---|---------|
| Owner's  Signature | |
| <p><i>Srinivasan</i> S. SRINIVASAN, B.E. (CIVIL), M.E. (STRUCT.) Civil Engineer & Licensed Surveyor Class I-No. 248 CORPORATION OF MADRAS E-163, 7th AVENUE (UPSTAIRS) BESANT NAGAR, MADRAS - 600 090</p> | |
| Job Title PROPOSED FLATS IN PLOT No. 37 F APPROVED LAYOUT LANo 1/91 dt 25-3-91 & PP/M.C.No 157/90 dated 11-2-91 IN RE-SURVEY No. 641 OF VELACHERY CORP. OF MS 42 DIV 148 UNIT 30 | |
| Drawing Title CORPORATION DRAWING FIRST FLOOR PLAN | |
| Drawn | Checked |
| Scale 1" = 4'0" | Date |
| TYPE - H 3 | SH 3/3 |

o/c

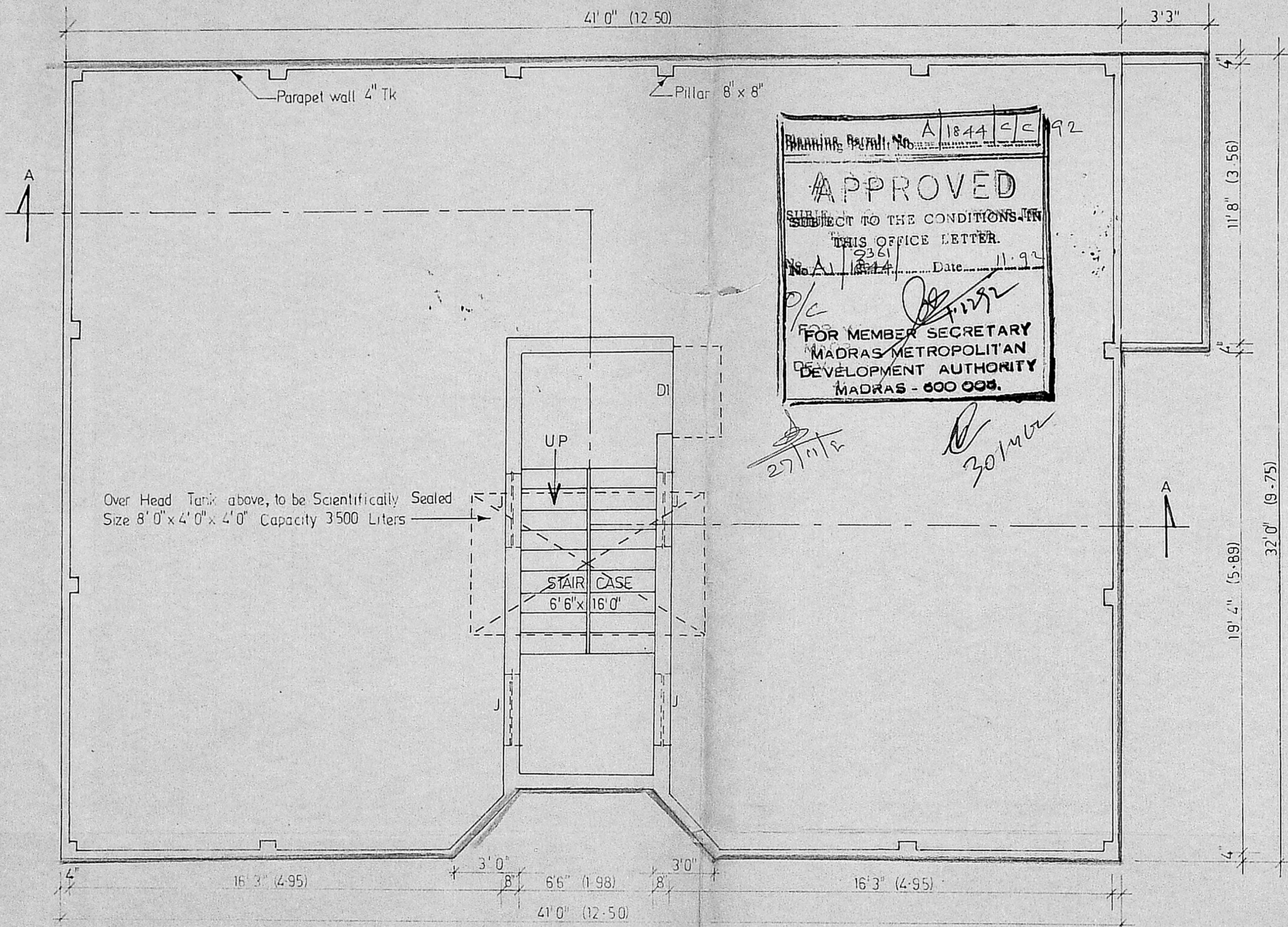

DRAWING No. A/1844/C/C/92
APPROVED
 SUBJECT TO THE CONDITIONS IN
 THIS OFFICE LETTER.
 No. A/1844 Date 11.92
 o/c
 27/11/92
 30/11/92
 FOR MEMBER SECRETARY
 MADRAS METROPOLITAN
 DEVELOPMENT AUTHORITY
 MADRAS - 600 090.

TERRACE FLOOR PLAN

| | |
|--|-------------------------------|
| <p>13-11-92</p> <p>OWNER</p> | |
| <p>Licensed Surveyor</p> <p style="text-align: center;"> S. SRINIVASAN, B.E. (CIVIL), M.E. (STRUCT.) Civil Engineer & Licensed Surveyor Class I-No. 248 CORPORATION OF MADRAS E-163, 7th AVENUE (UPSTAIRS) BESANT NAGAR, MADRAS - 600 090 </p> | |
| Job Title | * PP/M-C-NO 157/90 dt 11-2-91 |
| <p>PROPOSED FLATS IN PLOT No 37 APPROVED No. 1/91 dt 25-3-91 & IN RE-SURVEY No 641 OF VELACHERY CORP. OF MS 42 DIV 148 UNIT 30</p> | |
| <p>Drawing Title</p> <p style="text-align: center;">CORPORATION DRAWING</p> | |
| Drawn | Checked |
| Scale | Date |
| 1" = 4' 0" | 11-2-92 |
| TYPE-H3 | SH 2/3 |

13-11-92